

無法輸入 Floor Load

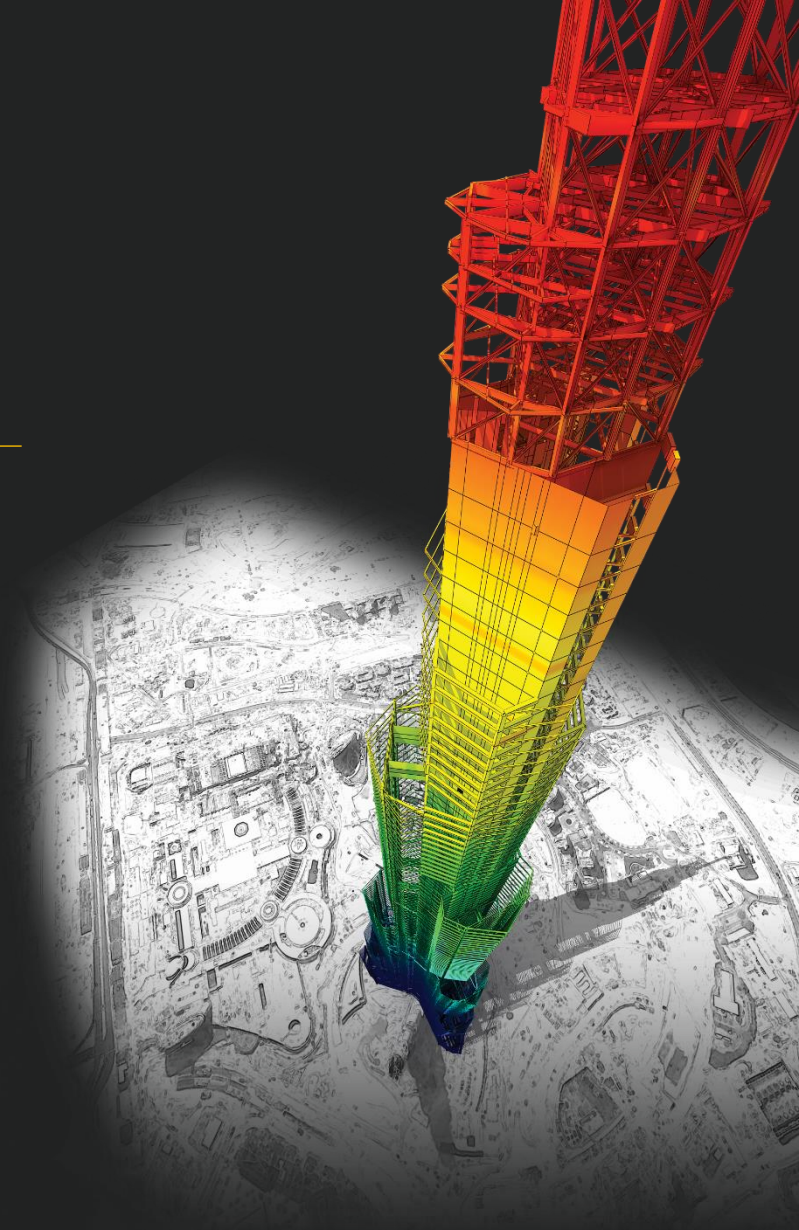

DESIGN OF General Structures

Integrated Design System for Building and General Structures

問題

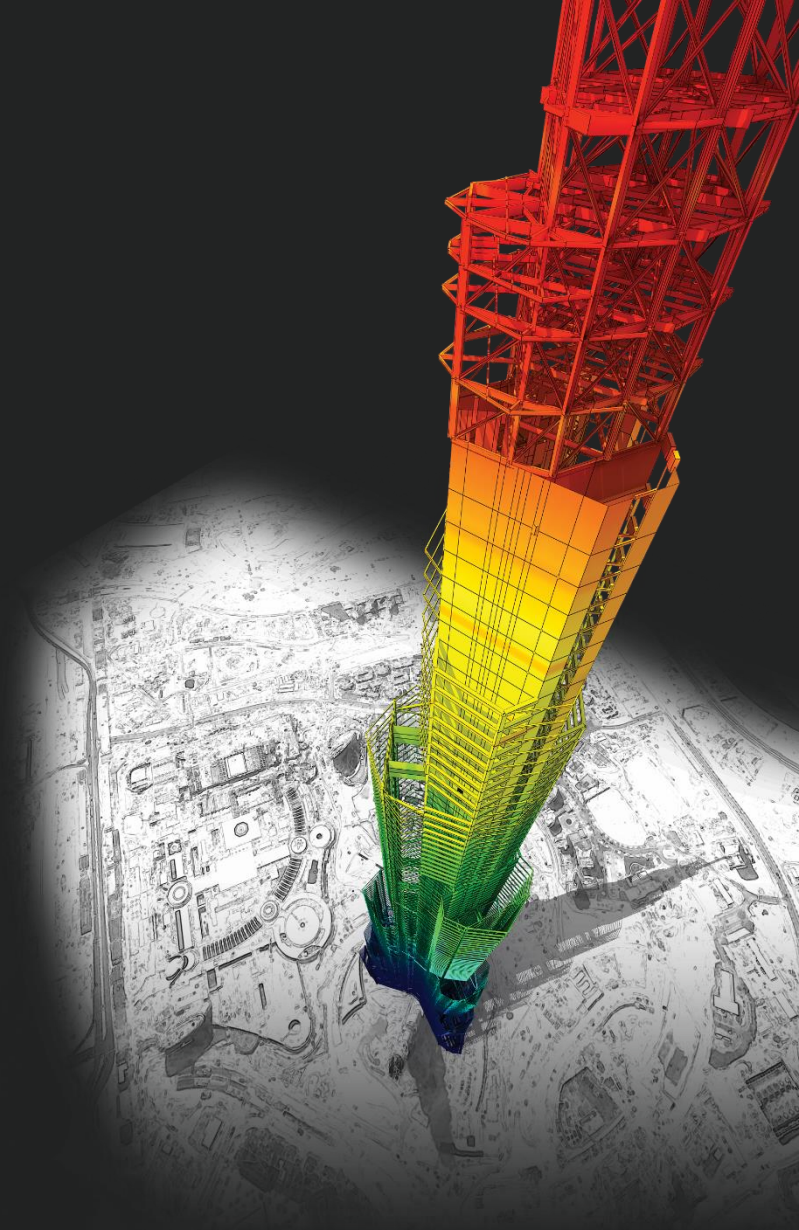

DESIGN OF General Structures

Integrated Design System for Building and General Structures

問題

我輸入 Floor Load 以後，有這樣的 Error Message。

“[Error] Floor Load (Number=24) contains errors. The unit loading area (considering Sub-Beam) should be a triangle or quadrangle”

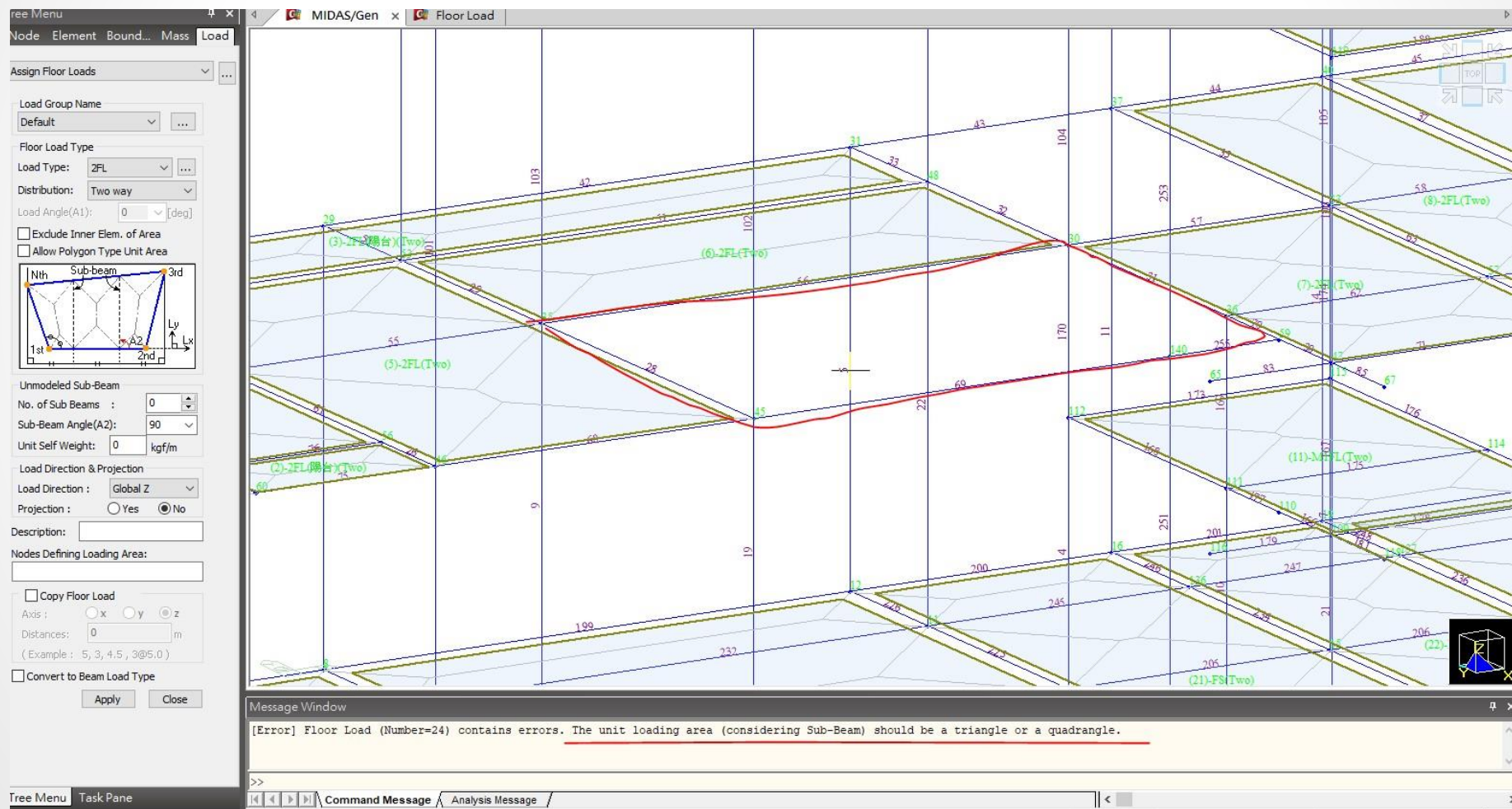

回答

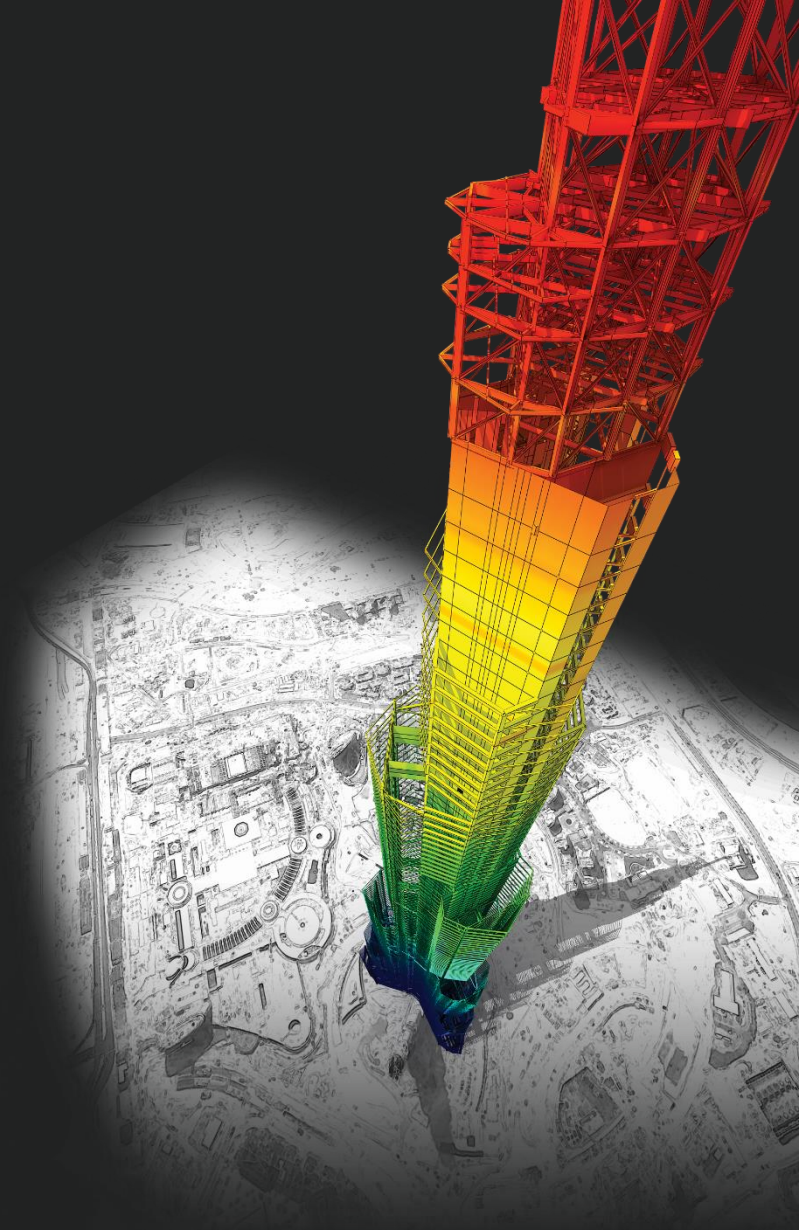

DESIGN OF General Structures

Integrated Design System for Building and General Structures

回答

我已經看你的檔案。
我看到 Element No.255 不是 Straight Element。

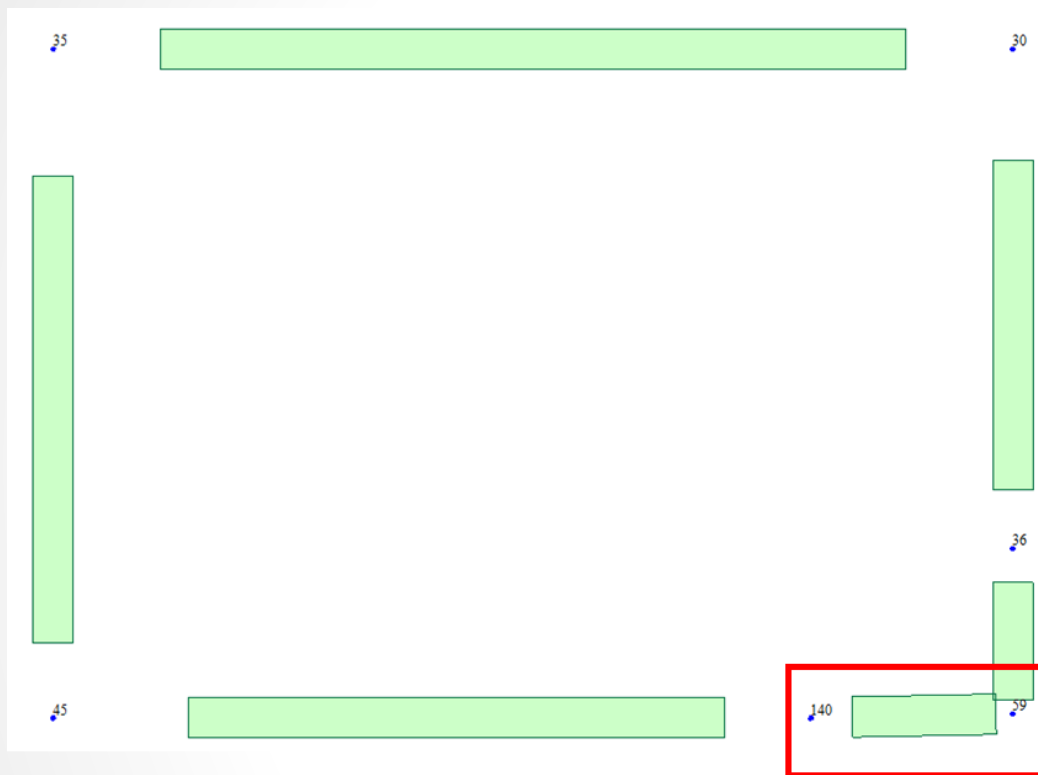

不是 Straight Beam Element。

```
The project will be saved by the auto-save feature.  
Node 140  
Coordinates : X=12.35, Y=1, Z=4.5  
Node 59  
Coordinates : X=13.6, Y=1.025, Z=4.5  
Distance from node 140 = 1.25025 (DX=1.25, DY=0.025, DZ=0)
```

回答

所以您應該改變那個 Nodes Location。

1. 您可以選 Node No.140 和 59。
2. 然後在 Query > 按 Detail Node Tables，請您改變 Node No.59 的 Y location。(在 Y(m) 您可以馬上輸入 1)

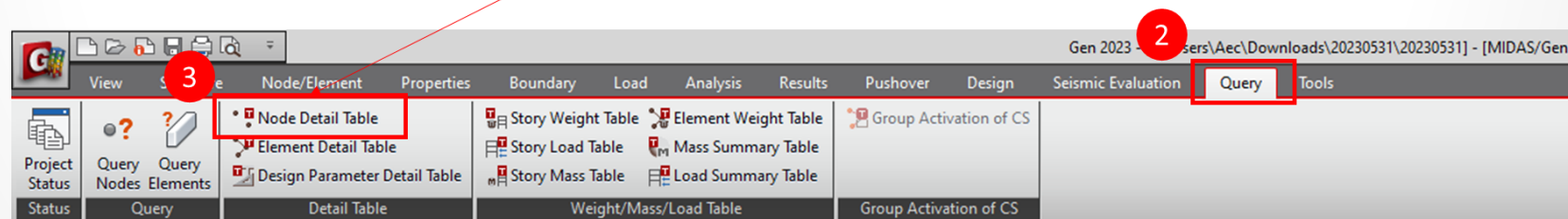
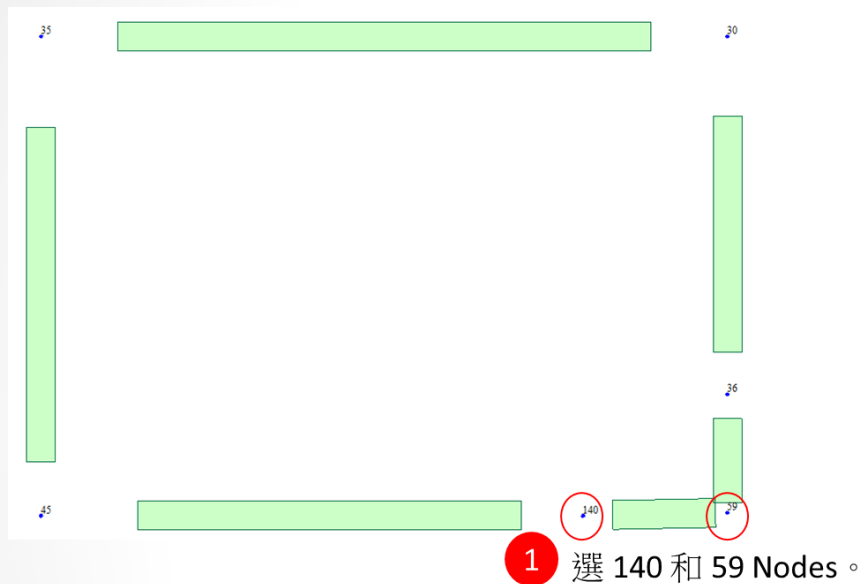

A screenshot of the 'Node Detail' table in the software. The table has columns for F, Node, X(m), Y(m), and Z(m). Node 59 is highlighted with a red box and labeled with a red '4'. Node 140 is also highlighted with a red box. The Y(m) value for Node 59 is 1.025000, and for Node 140 it is 1.000000.

F	Node	X(m)	Y(m)	Z(m)
▶	59	13.600000	1.025000	4.500000
	140	12.350000	1.000000	4.500000
*				

A screenshot of the 'Node Detail' table in the software. The table has columns for F, Node, X(m), Y(m), and Z(m). Node 59 is highlighted with a red box and labeled with a red '4'. Node 140 is also highlighted with a red box. The Y(m) value for Node 59 is 1.000000, and for Node 140 it is 1.000000.

F	Node	X(m)	Y(m)	Z(m)
▶	59	13.600000	1.000000	4.500000
	140	12.350000	1.000000	4.500000
*				

回答

改變 Node Location 以後，您可以看您的 Beam Element 已經 Straight Beam Element。
然後輸入 Floor Loads 應該沒有問題。

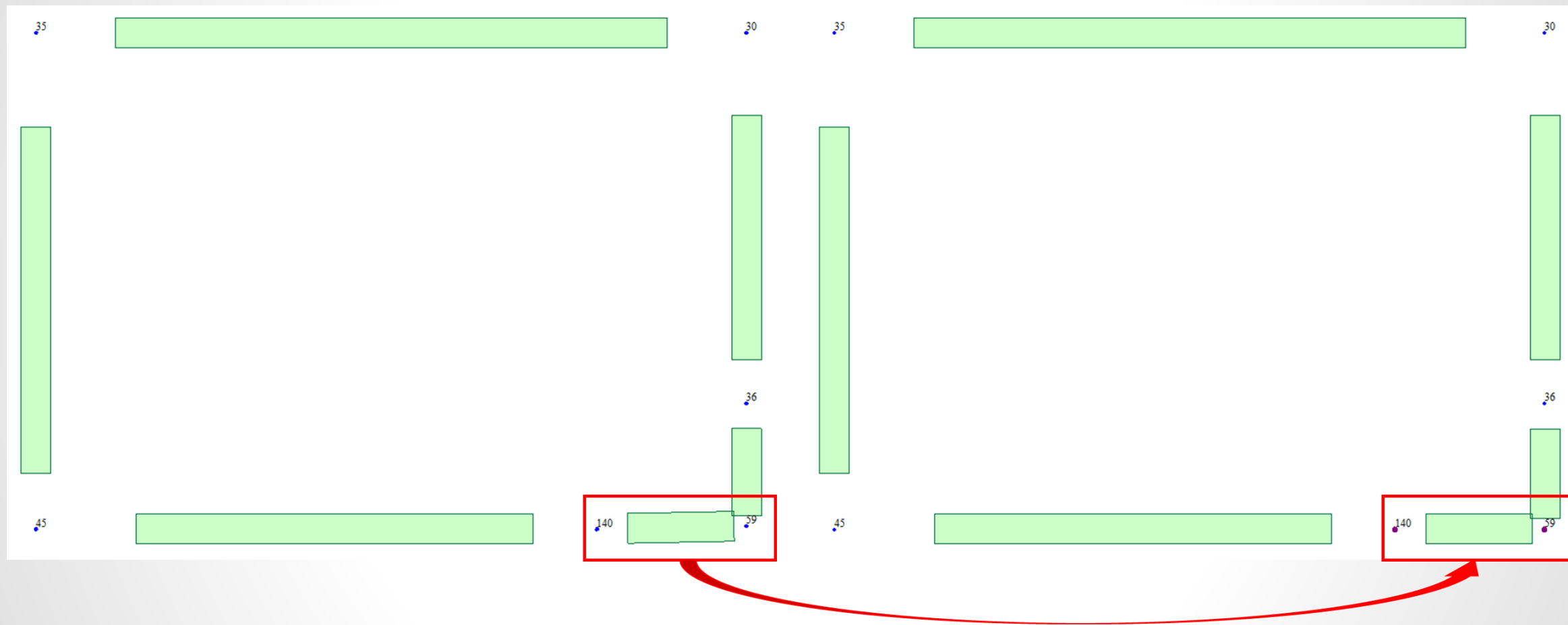

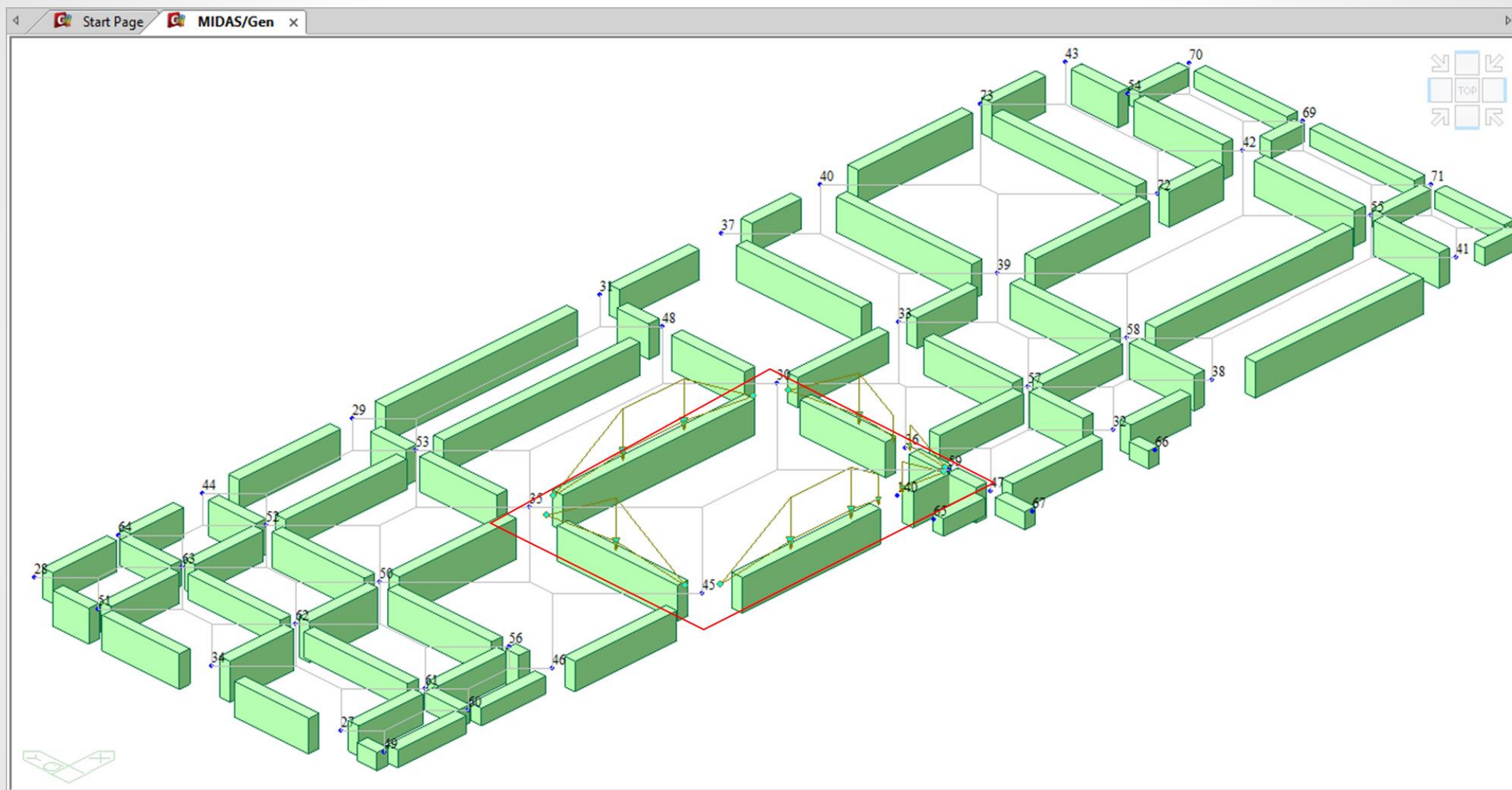

Thank You

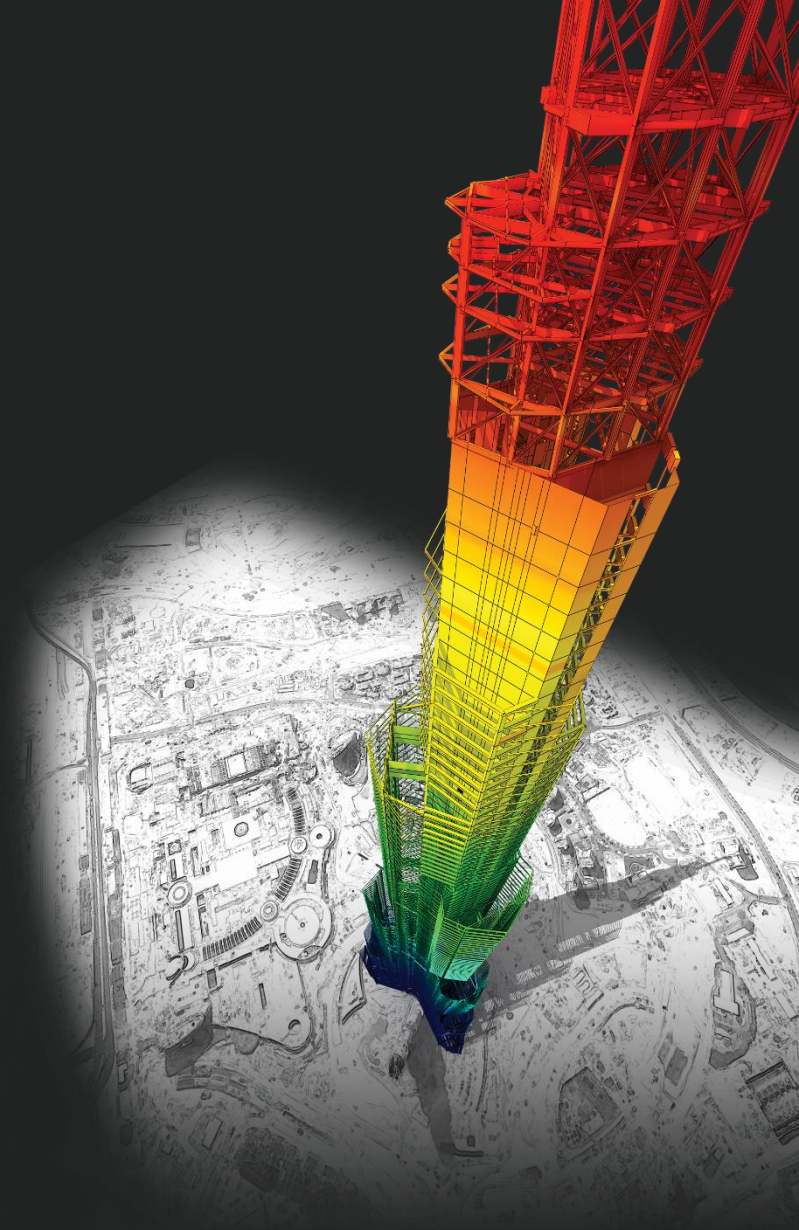

DESIGN OF General Structures

Integrated Design System for Building and General Structures