

如何模擬鋼梁用加勁版

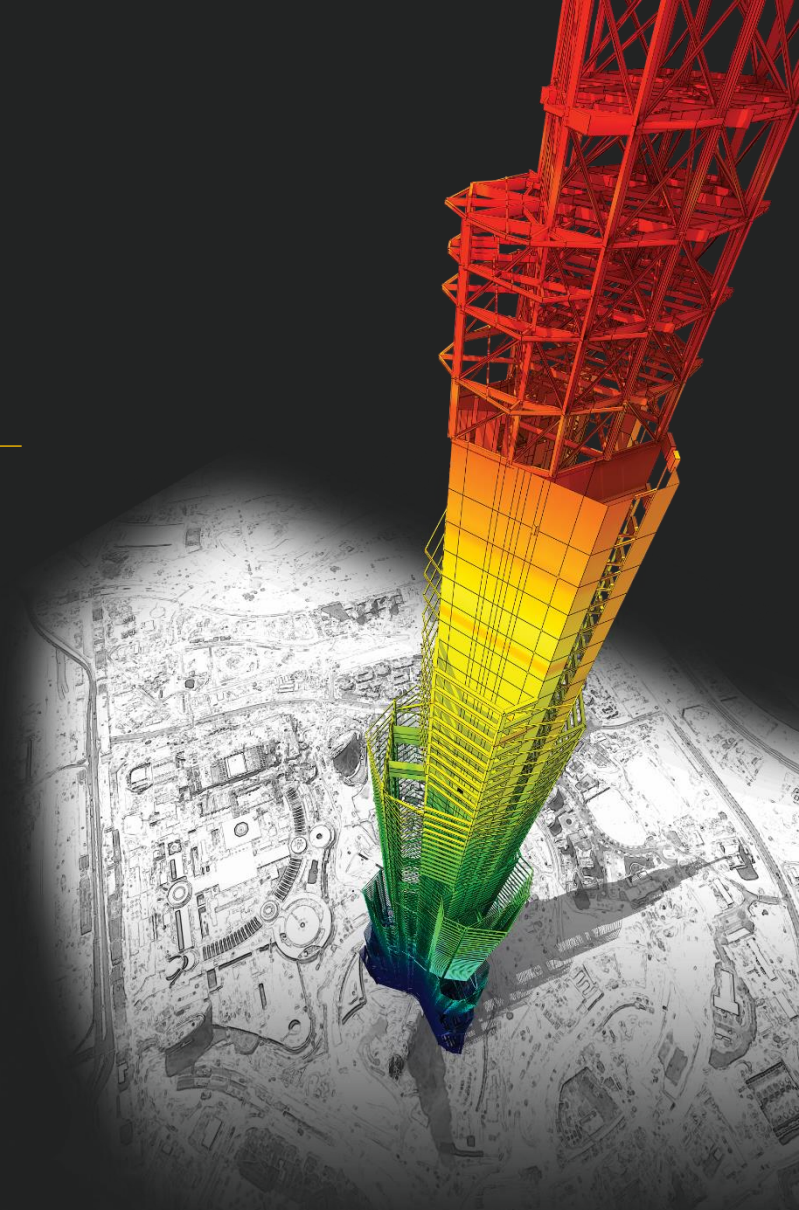

DESIGN OF General Structures

Integrated Design System for Building and General Structures

問題

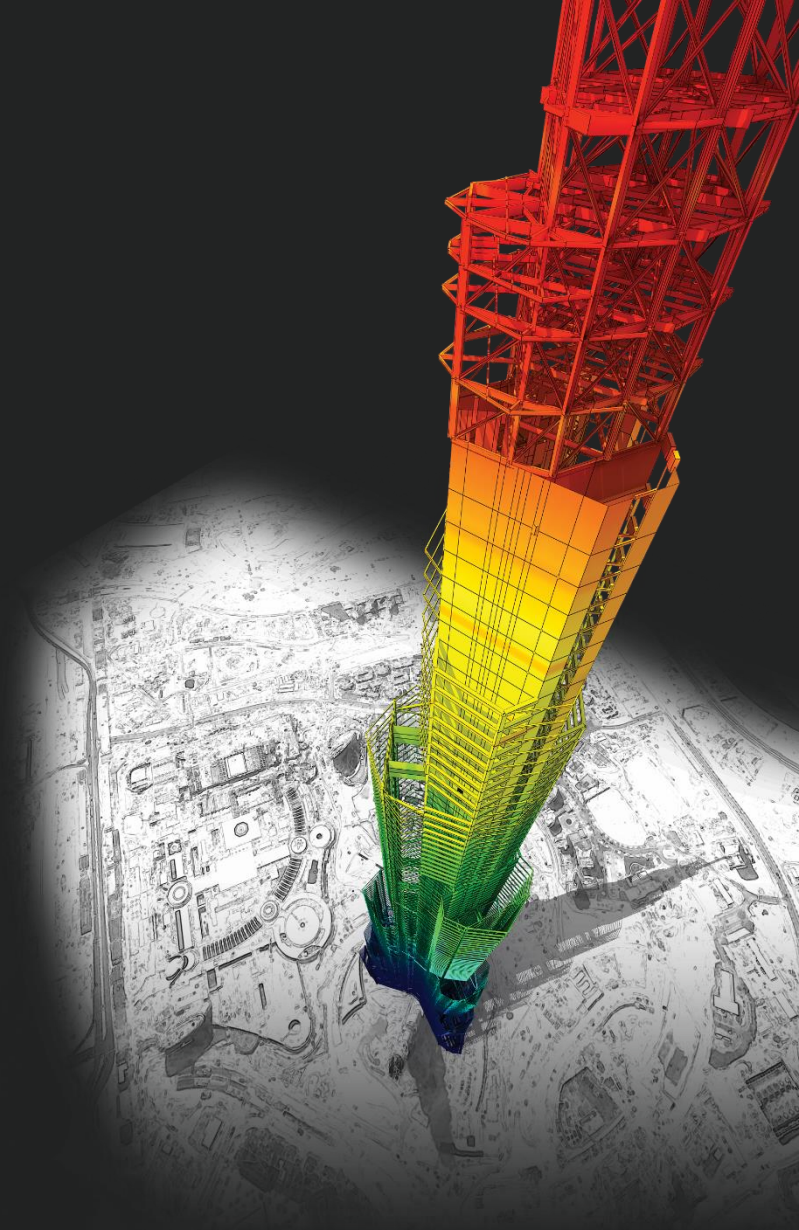

DESIGN OF General Structures

Integrated Design System for Building and General Structures

問題

若鋼梁有如下圖這種加勁版，在模型中要如何模擬?
(梁為H型鋼，該加勁版平行於H梁腹板，並焊接於上下翼板端點處)

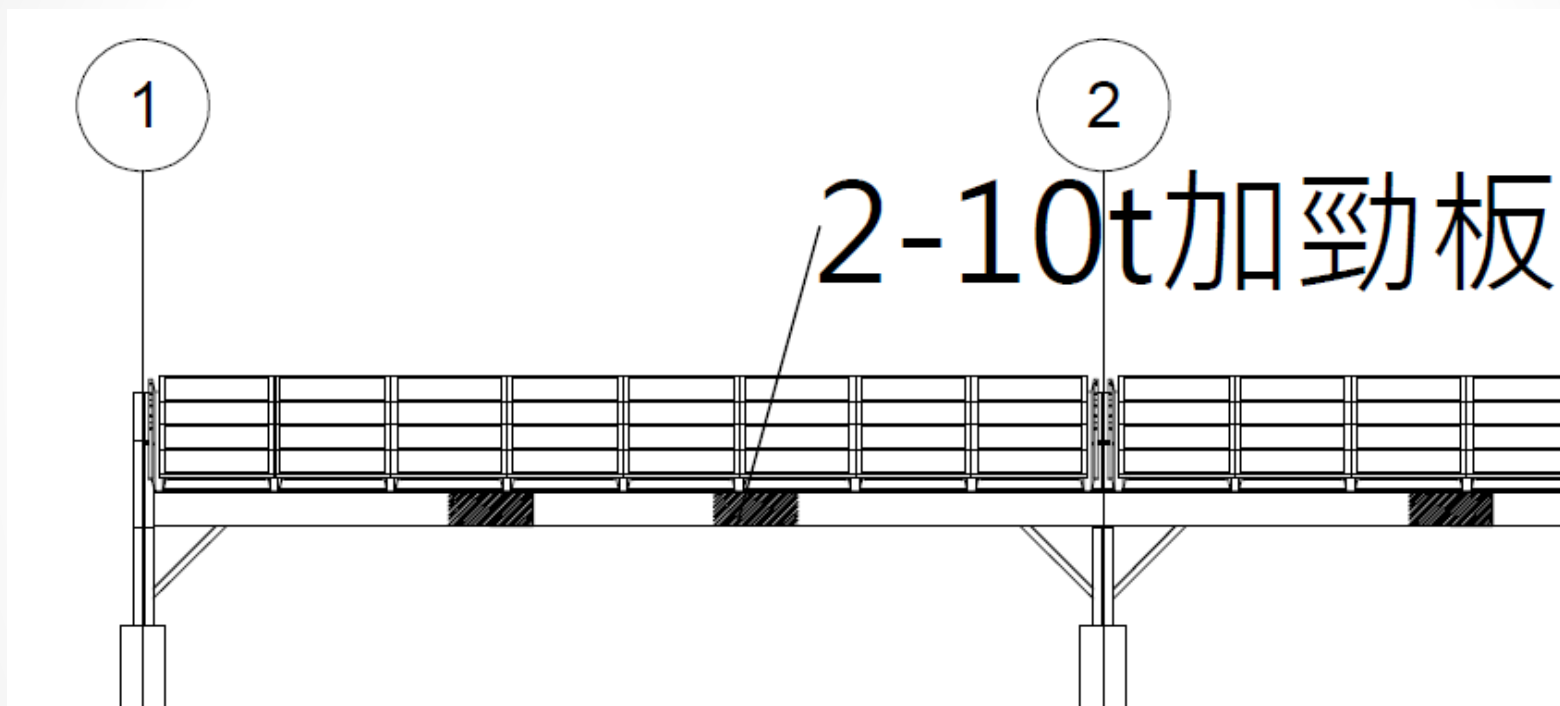

回答

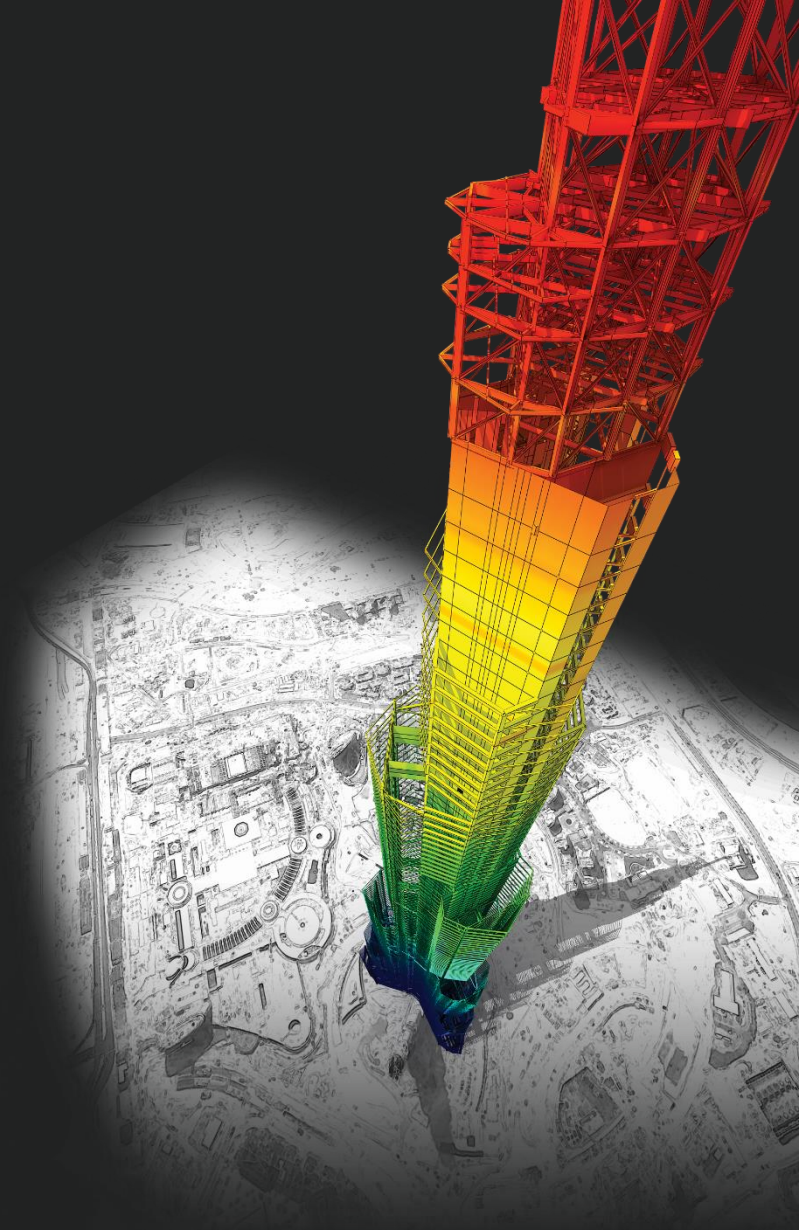

DESIGN OF General Structures

Integrated Design System for Building and General Structures

這個問題您可以做兩個斷面。

一個沒有 Stiffening Plate

一個有 Stiffening Plate。

比如說我的梁尺寸是 RH 300x150x6.5x9。

所以我加 B1 是 RH 300x150x6.5x9。

然後我加另外一個斷面是 B2。

B2 的尺寸跟 B1 的一樣，但是 B2 的 Web thickness 是 6.5 (RH 300x150x6.5x9 的 Web thickness) + 2x1.0 (2-10t Stiffening Plate 的厚度)。

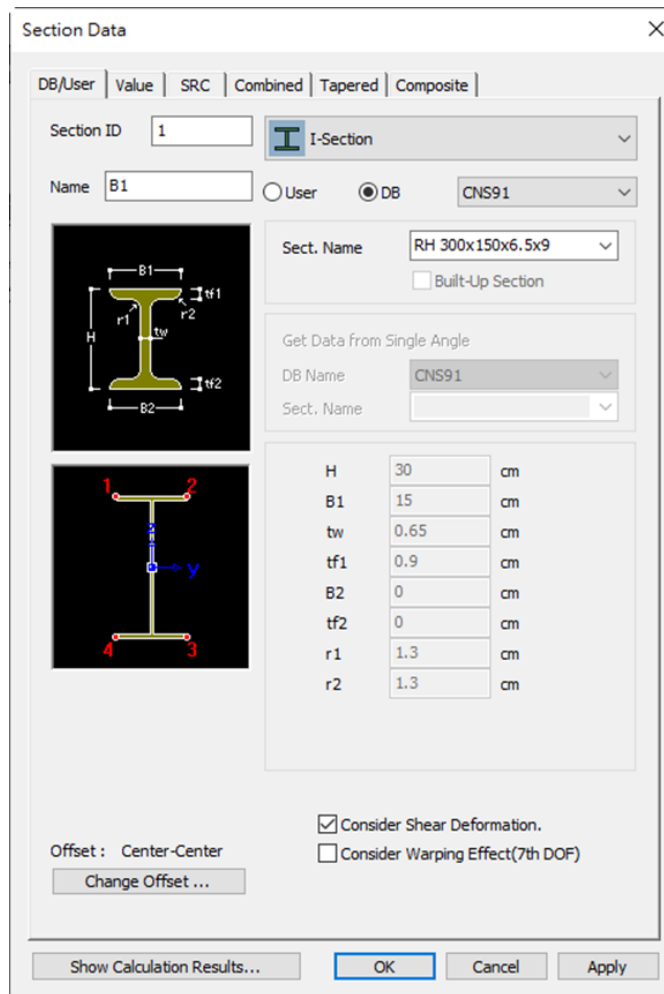

沒有 Stiffening Plate。

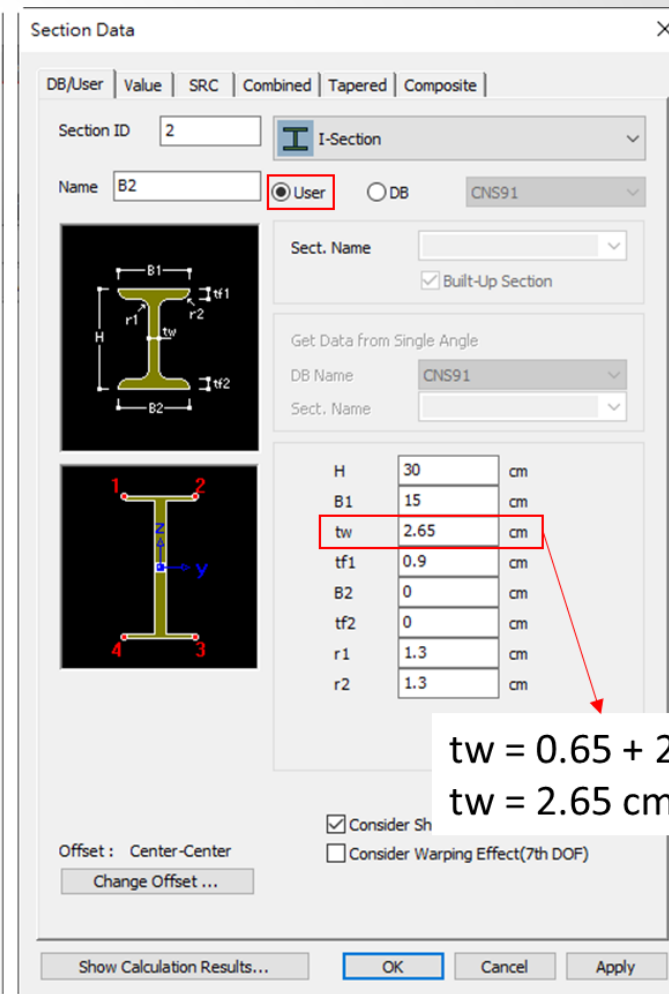

有 Stiffening Plate。

回答

然後您可以建立那個梁。

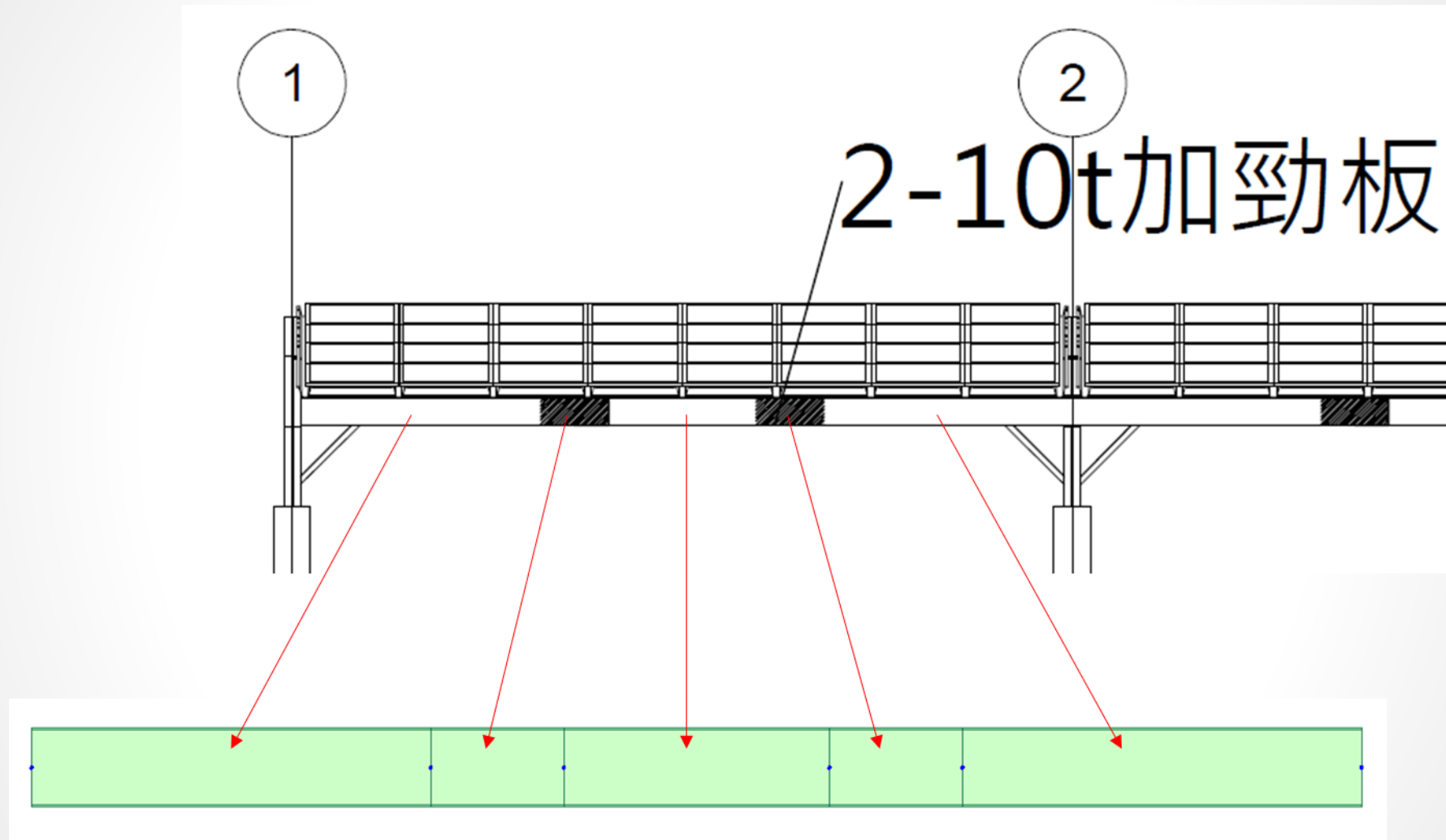

Thank You

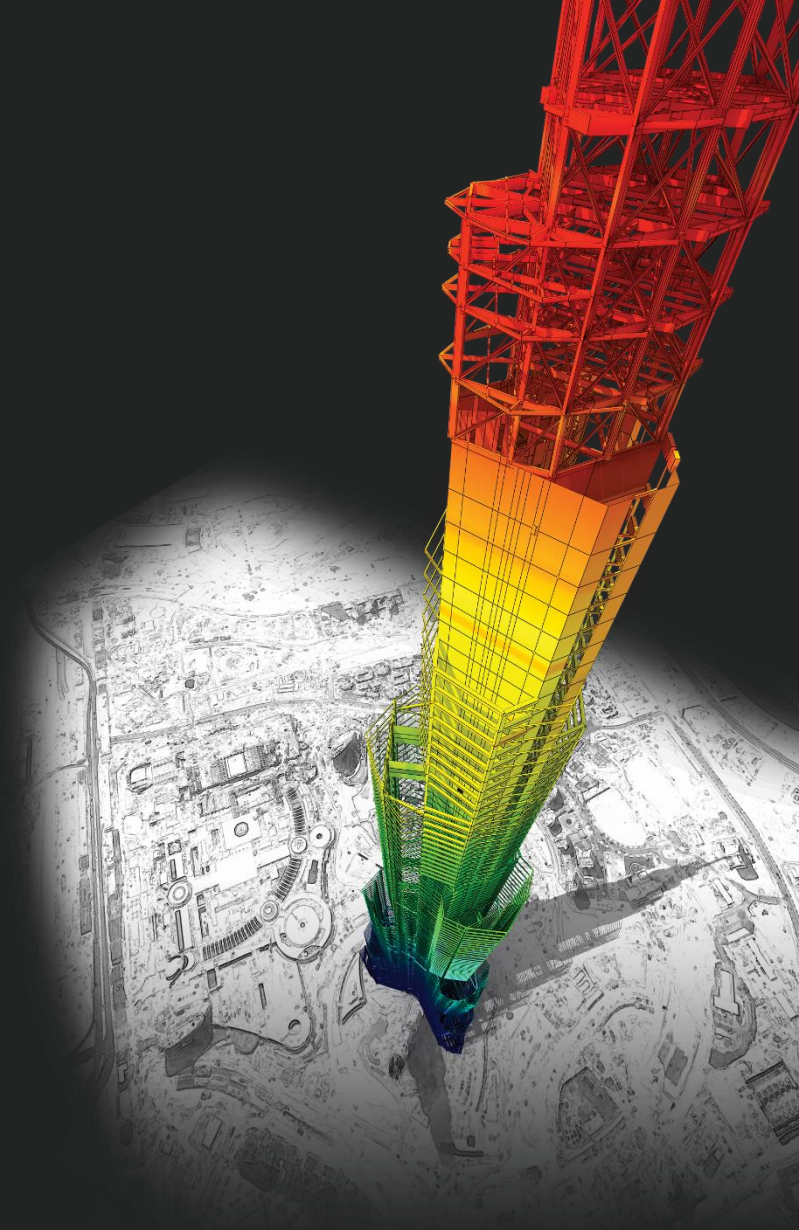

DESIGN OF General Structures

Integrated Design System for Building and General Structures