

No Element Exist for Generation Section Design+ Error Message

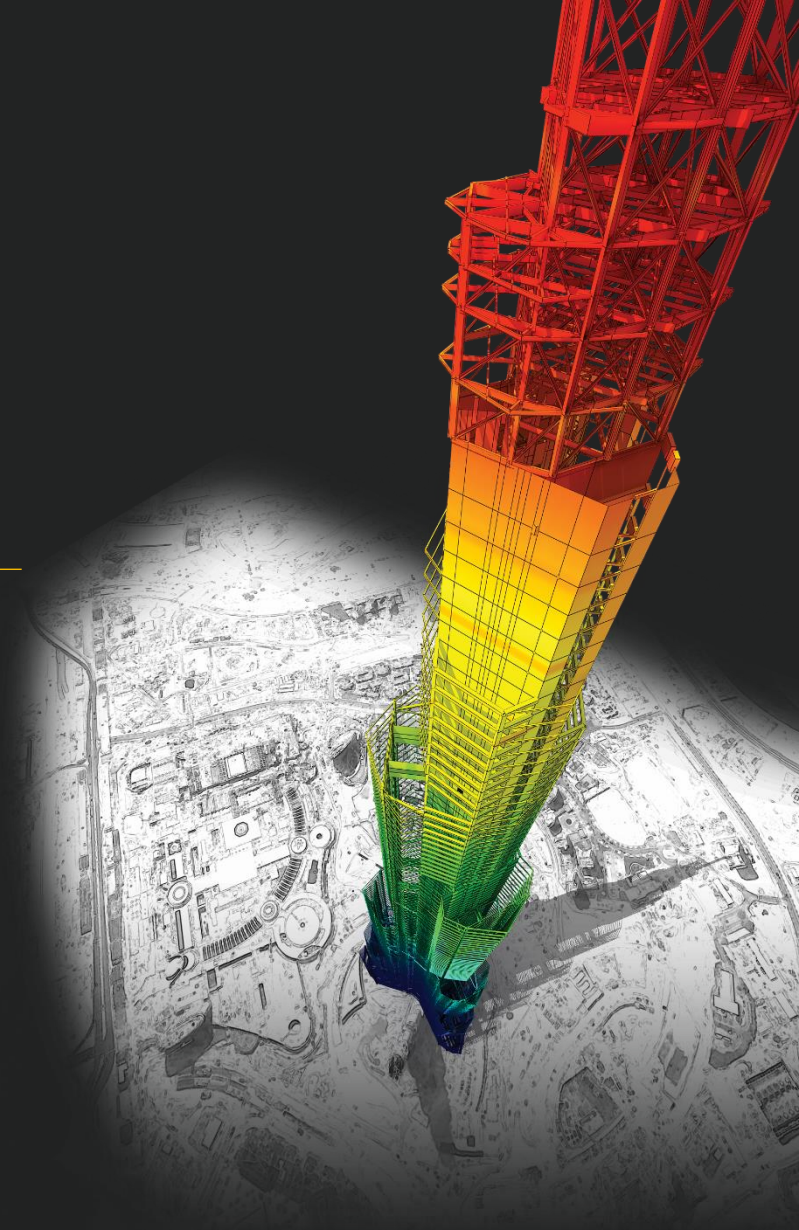

DESIGN OF General Structures

Integrated Design System for Building and General Structures

問題

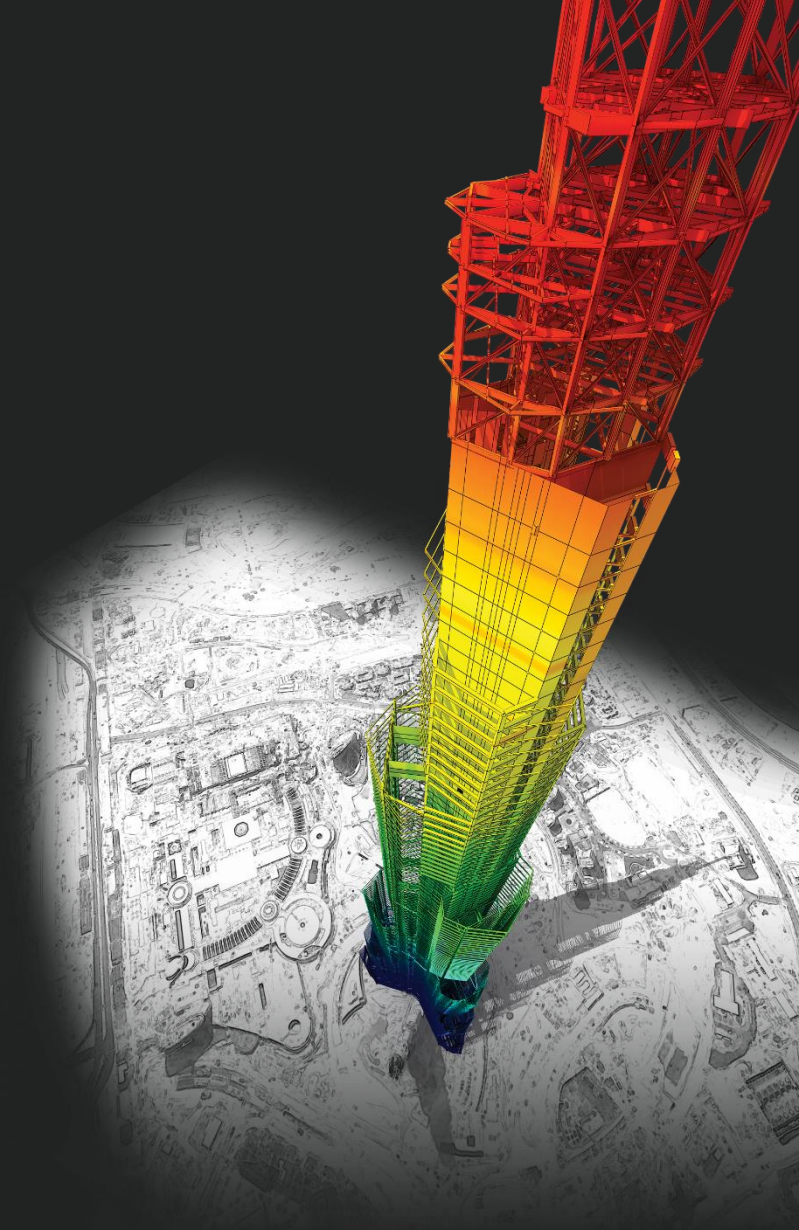

DESIGN OF General Structures

Integrated Design System for Building and General Structures

問題

目前計算分析鐵塔基礎的結構問題，於MIDAS分析完成後，於DESIGN內設計基礎版，需將模型內基礎的力匯入DESIGN+進行分析時發生錯誤，附上分析的模型檔案。

目前使用的版本是MIDAS GEN 2020 及 Design+ 2020。

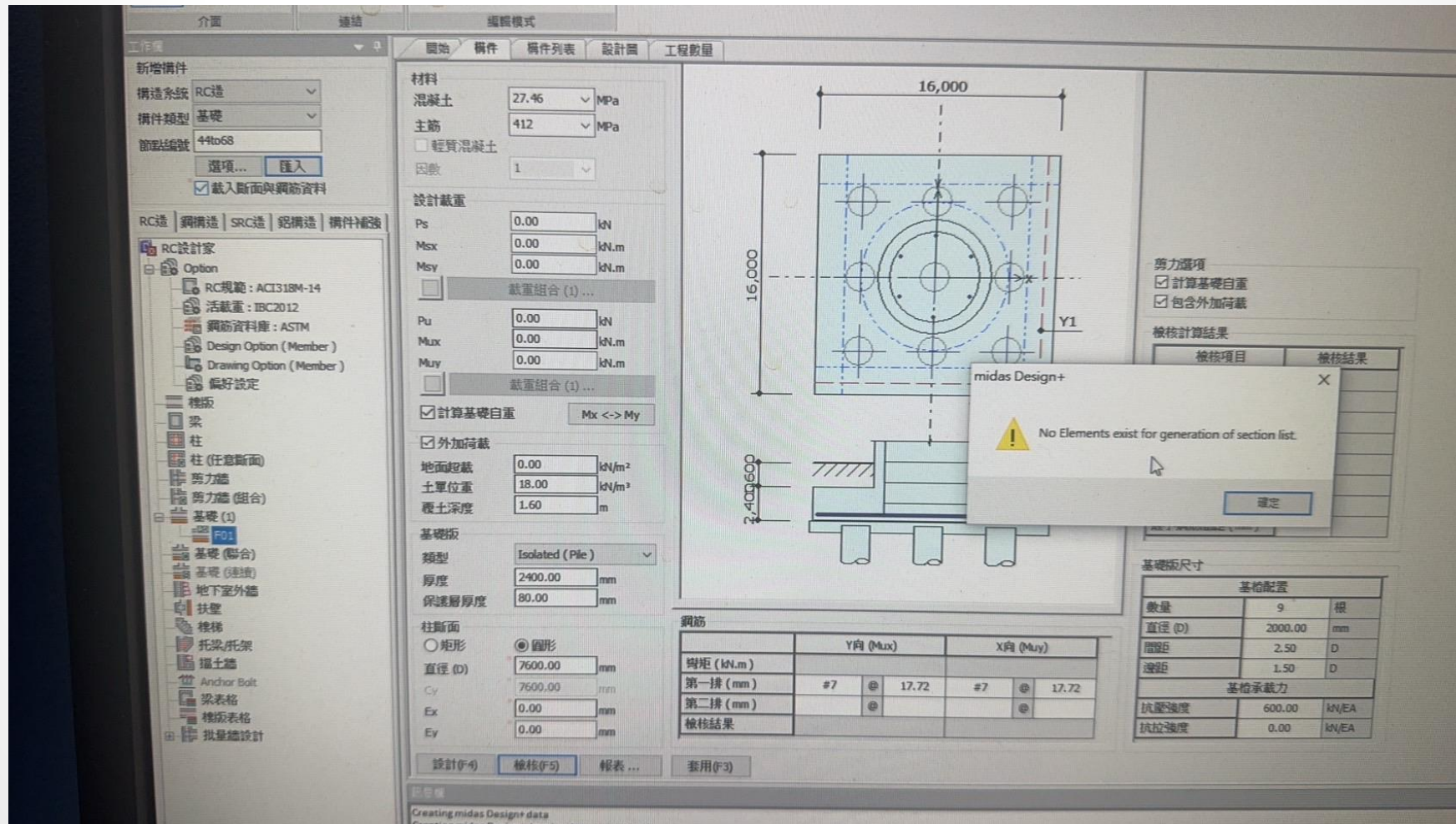

回答

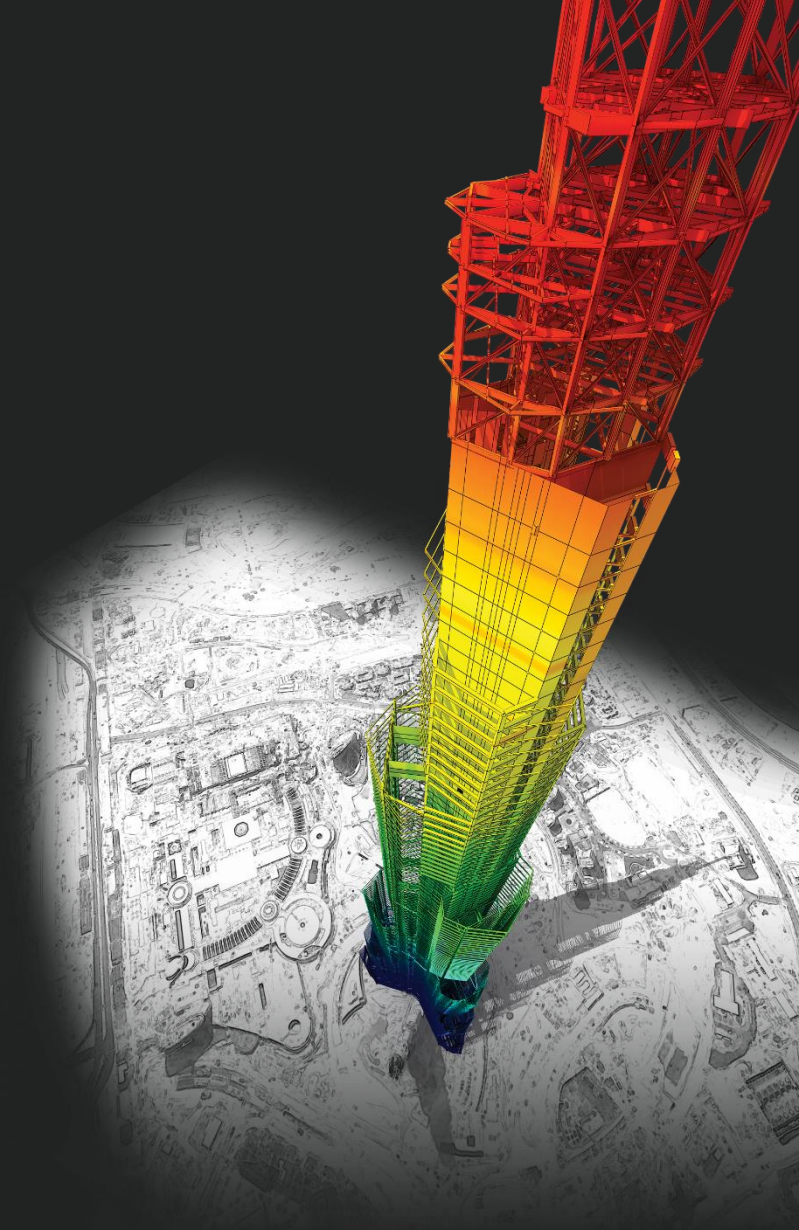

DESIGN OF General Structures

Integrated Design System for Building and General Structures

回答

在柱子的下面，您還沒輸入邊界條件。
輸入邊界條件以後，Midas Link 功能應該可以匯入。

The screenshot displays the Midas Link software interface. On the left, a 3D model shows a column on a grid. A red circle highlights the column's base, with a red arrow pointing to the text "輸入邊界條件" (Input boundary conditions). The main window is divided into several panels:

- WorkBar:** Shows "Add new member" with "System" set to RC, "Type" to Footing, and "Node" to 44. The "Import" button is highlighted.
- Member Properties:** Shows details for member "0C1(44)", including material (Concrete), main bar (4079), and design load parameters.
- Design Load:** Lists load combinations and includes checkboxes for "Include Self-Weight" and "Surcharge Load".
- Footing Properties:** Shows "Type" as Isolated (Mat), "Depth" as 70.00 cm, and "Cover" as 8.00 cm.
- Column Section:** Shows "Circle" as the selected section type with a diameter of 760.00 cm.
- Rebar:** A table showing rebar details for Y and X directions.
- Calculation Result:** A table of design checks.
- Footing Size:** A table showing footing dimensions (Lx, Ly) and soil bearing capacity.

At the bottom, buttons for "Design(F4)", "Check(F5)", "Report...", and "Apply(F3)" are visible.

Check Items	Result
Soil Bearing (tonf/m ²)	1.620 OK(0.159)
1Way Shear-X (tonf)	223 OK(0.578)
1Way Shear-Y (tonf)	208 OK(0.560)
2Way Shear (tonf)	444 OK(0.310)
Min. Bar Ratio (cm ²)	0.200% 14.00
Max. Bar Space (cm)	D25 @36.21

FOOTING SIZE		
Lx	10.00	m
Ly	10.00	m

Capacity(fe)	10.19716212978	tonf/m ²
--------------	----------------	---------------------

	Y-Direction (Mux)		X-Direction (Muy)	
Moment (tonf.m)	25.30		27.77	
Layer 1 (cm)	D25	@ 45.00	D25	@ 45.00
Layer 2 (cm)		@		@
Result	NG(1.071)		NG(1.126)	

Thank You

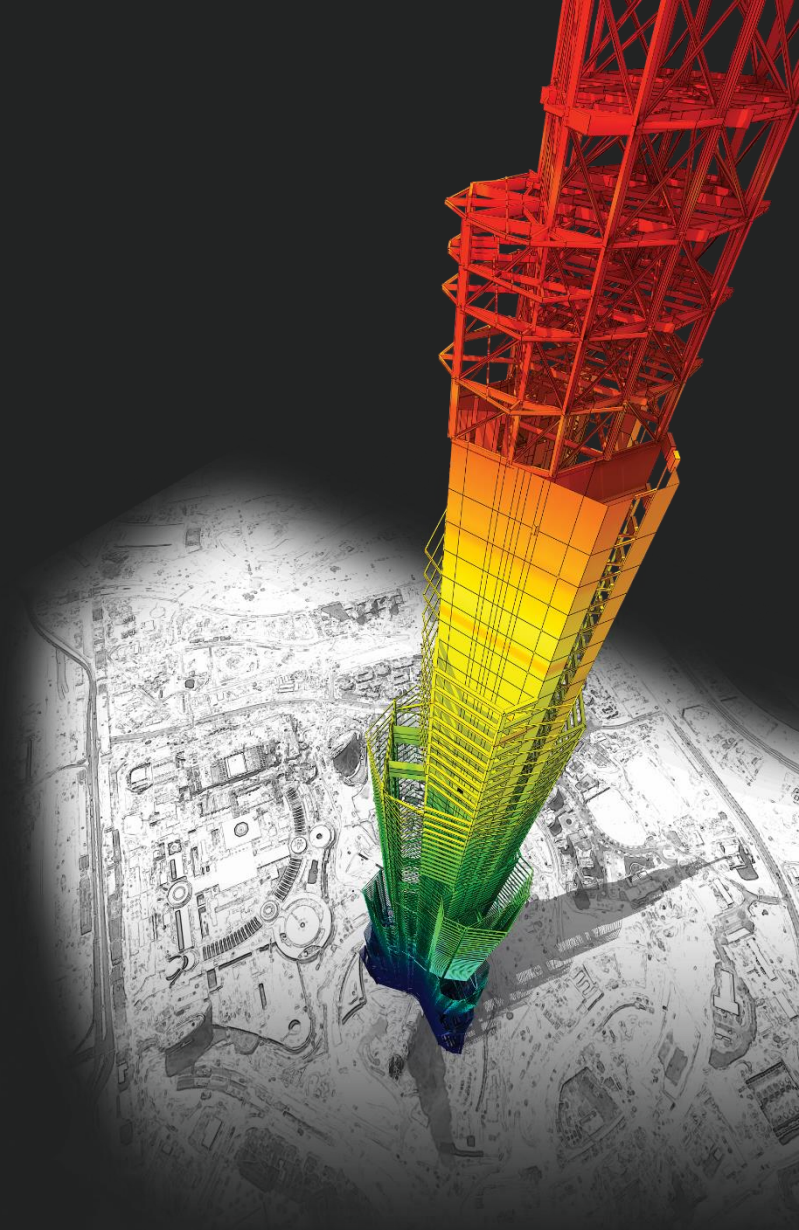

DESIGN OF General Structures

Integrated Design System for Building and General Structures